

WAVLINK



see the world

Universal Quad Display Docking Station with 5Gbps Ethernet Port

Model: WL-UMD323

@WavlinkOfficial

@WavlinkTechSupport

Table of contents:

- About This Guide
 - Conventions
 - More Info
 - Performance Disclaimer
 - Safety Instructions
 - Copyright Statement
 - WEEE Directive & Product Disposal
- Chapter 1 Basic Information
 - Introduction
 - Feature
 - System Requirement
 - Overview
- Chapter 2 Display Specification and Operation
 - Display Resolution
 - Connection
 - Display Mode Setting
 - For Windows Users
 - For macOS Users
- Chapter 3 Tips and Notice
 - Tips
 - Notice
- Chapter 4 FAQ and Aftersale Service
 - FAQ
 - Q1. Why there is no video output?
 - Q3. Why doesn't my docking station charge my laptop?
 - Q4. How to figure out the maximum resolution (DP 2.1 / HDMI 2.1) my laptop supports?
 - Q5. My Laptop/Desktop supports PD and DP ALT MODE, why is it still not working properly?
 - Aftersale Service

About This Guide

This guide serves as a companion to the Quick Installation Guide for your wired USB product. The Quick Installation Guide provides essential steps for immediate setup, while this document offers detailed explanations of product features and advanced configuration options.

Please note that product functionality may vary slightly depending on your specific model, software version, geographic region, language, and connected devices. Screenshots, parameters, and descriptions in this guide are for illustrative purposes only.

Conventions

In this guide the following conventions are used :

Convention	Description
<u>Underlined</u>	Underlined words or phrases are hyperlinks. You can click to redirect to a website or a specific section.
Teal	The content and text that needs to be emphasized on the web page is the theme color #1D428A , including menus, items, buttons, etc.
Note:	Critical reminders to prevent operational errors or functionality issues.
Tips:	Best practices or optimization suggestions for enhanced performance.

More Info

The latest driver, firmware and utilities are available from the Download Center at [WAVLINK SUPPORT](#) .

Included in your product packaging or available digitally via the link above.

If you encounter any issues, please don't hesitate to email contact@wavlink.com / techsupport@wavlink.com / postsales@wavlink.com to provide feedbacks or contact online customer service, thank you !

Performance Disclaimer

The maximum transfer speeds stated for this product are based on theoretical limits of USB specifications (e.g., USB 2.0/3.0/3.1 Gen 1/Gen 2). Actual performance may vary due to:

Device limitations: Host system performance, driver compatibility, and connected device capabilities.

Environmental factors: USB cable quality, length, electromagnetic interference, and port power delivery.

Network/software conditions: Operating system overhead, background processes, and concurrent data transfers.

Wired connections are generally more stable than wireless alternatives, but performance is not guaranteed and depends on the factors listed above.

Information in this document is subject to change without notice. The manufacturer does not make any representations or warranties (implied or otherwise) regarding the accuracy and completeness of this document and shall in no event be liable for any loss of profit or any commercial damage, including but not limited to special, incidental, consequential, or other damage.

Safety Instructions

Always read the safety instructions carefully.

Keep this Quick Start Guide for future reference.

Keep this equipment away from humidity.

If any of the following situation arises, get the equipment checked by a service technician:

□ The equipment has been exposed to moisture.

□ The equipment has been dropped and damaged.

□ The equipment has an obvious sign of breakage.

□ The equipment has not been working well or you cannot get it work according to Quick start Guide.

Copyright Statement

No part of this publication may be reproduced in any form by any means without the prior written permission.

Other trademarks or brand names mentioned herein are trademarks or registered trademarks of their respective companies.

WEEE Directive & Product Disposal

At the end of its serviceable life, this product should not be treated as household or general waste. It should be handed over to the applicable collection point for the recycling of electrical and electronic equipment, or returned to the supplier for disposal.



Chapter 1 Basic Information

This chapter introduces the docking station's features, appearance, and some basic information.

It contains the following sections :

- [Introduction](#)
- [Feature](#)
- [System Requirement](#)
- [Overview](#)

Introduction

This quad display docking station provides crystal clear display up to 4 x 4K@60Hz. A Gigabit LAN port supports lightning-fast cable connection up to 5000Mbps and backward 2500/1000/100/10Mbps, offering a lag-free gaming experience. USB-C port supports upstream 90W to your laptop and 10W downstream charging for other devices. It deserves to be called a good assistant for your working, gaming, and video playing.

Feature

- 2 x DP 2.1 ports and 2 x HDMI 2.1 ports can quadruple extend or mirror your screen up to vivid 4K@144Hz.
- 1x 5Gbps LAN port speeds up your gaming and streaming playing backward 2500/1000/100/10Mbps.
- 1 x USB-C port supports 90W upstream charging to your laptop, and 10W downstream charging to other devices.
- Driver-free, plug and play.

System Requirement

- Microsoft Windows 10 / 11
- Apple Mac OS 10.8 or later

Overview

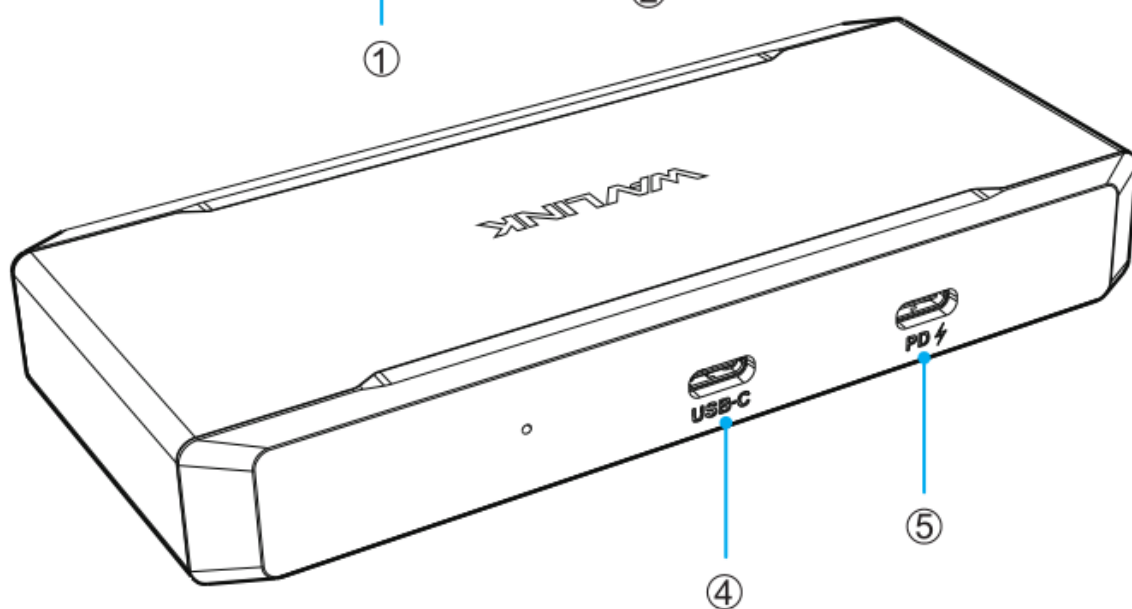
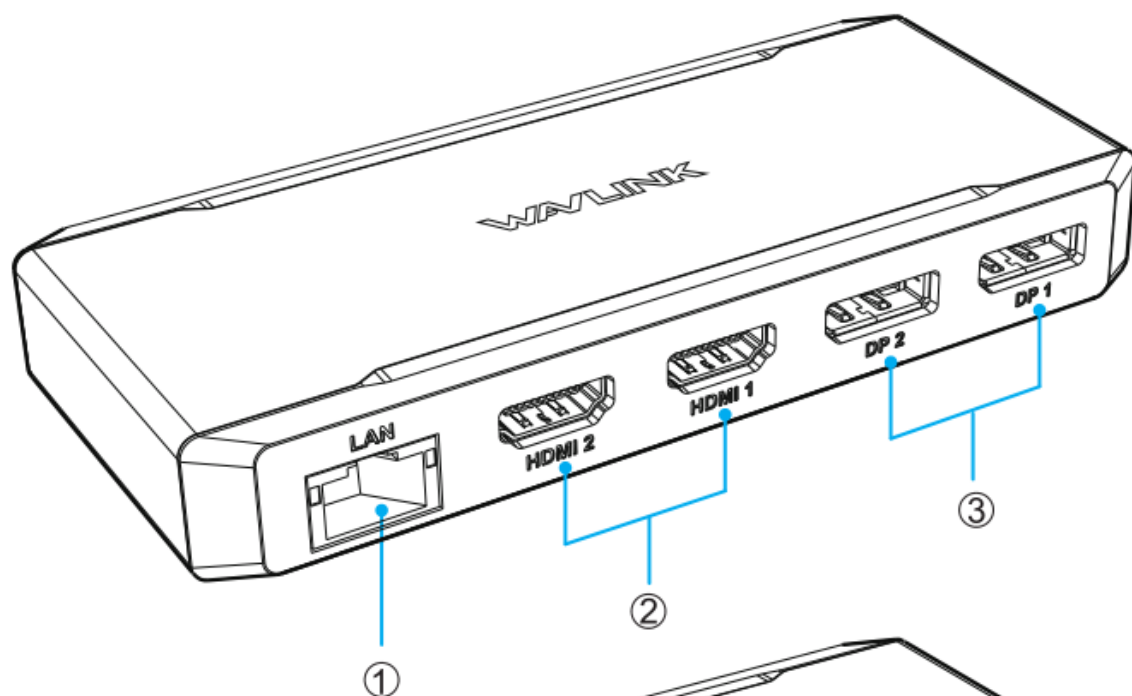

① 5G LAN

② HDMI

③ DP

④ Host

⑤ PD IN 100W

Chapter 2 Display Specification and Operation

This chapter introduces the docking station's display resolution, connection, and display setting.

It contains the following sections :

- [Display Resolution](#)
- [Connection](#)
- [Display Mode Setting](#)

Display Resolution

Scenarios	Systems	Connected with DP 2.1 & DSC Computer	Connected with DP 1.4 & DSC Computer
Single Display	Windows	1: Single HDMI 4K@120Hz 2: Single DP 4K@144Hz	1: Single HDMI 4K@120Hz 2: Single DP 4K@144Hz
	macOS	1: Single HDMI 4K@120Hz 2: Single DP 4K@144Hz	1: Single Mirror: HDMI 4K@120Hz 2: Single DP 4K@144Hz
Dual Display	Windows	1: Dual DP 4K@144Hz 2: Dual HDMI 4K@120Hz 3: Single HDMI 4K@120Hz + Single DP 4K@144Hz	Dual HDMI/DP 4K@60Hz
	macOS	Mirror: Dual 4K@60Hz	Mirror: Dual HDMI/DP 4K@60Hz
Triple Displays	Windows	1: Single DP 4K@144Hz + Dual HDMI 4K60Hz 2: Single HDMI 4K@120Hz + Dual DP 4K@60Hz	Dual DP 4K@60Hz+ Single 4K@30Hz HDMI
	macOS	Mirror: Triple 4K@60Hz	Mirror: Triple HDMI/DP 4K@60Hz
Quad Display	Windows	Quad 4K@60Hz	Single DP 4K 60Hz+Triple DP/HDMI 1080P @60Hz
	macOS	Mirror: Quad 4K@60Hz	Mirror: Quad HDMI/DP 4K@60Hz

NOTE:

Mac OS only supports Mirror Mode in Dual Display.

On Windows, the Quad display turns off the laptop screen.

Connection

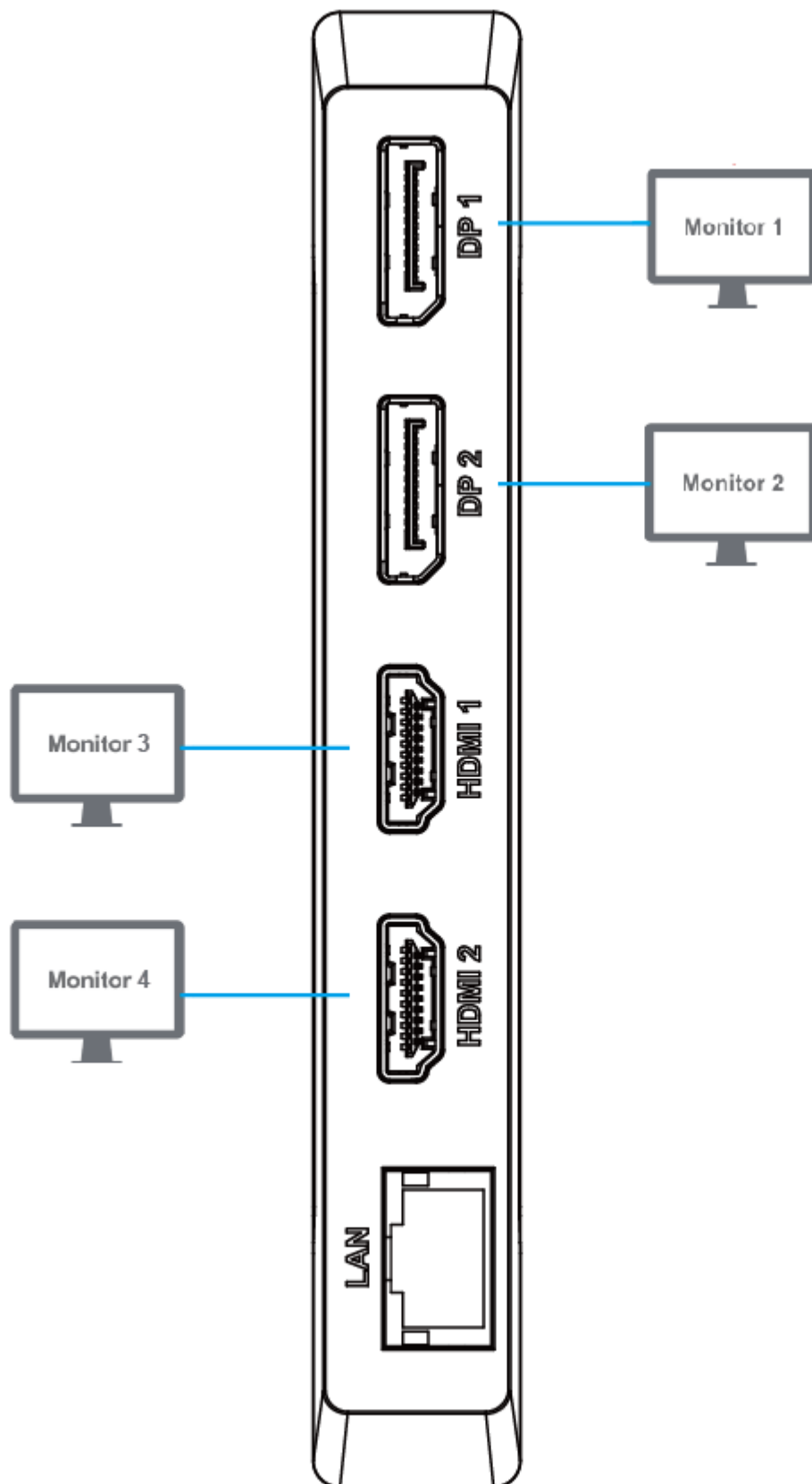

Display Mode Setting

For Windows Users

1.Right click on any spot on your desktop and select "**Display settings**".

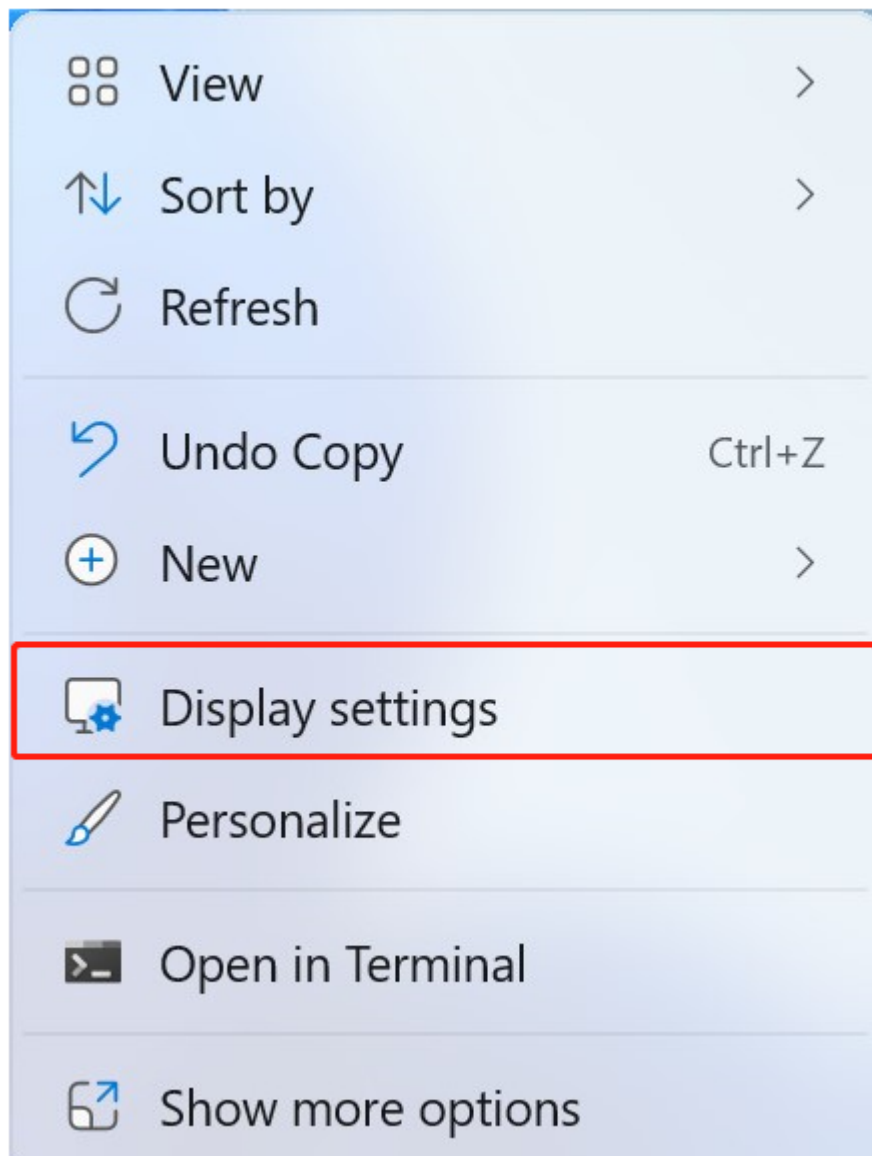

2.In "**Display**", please choose either monitor 2, monitor 3, monitor 4 or monitor 5.

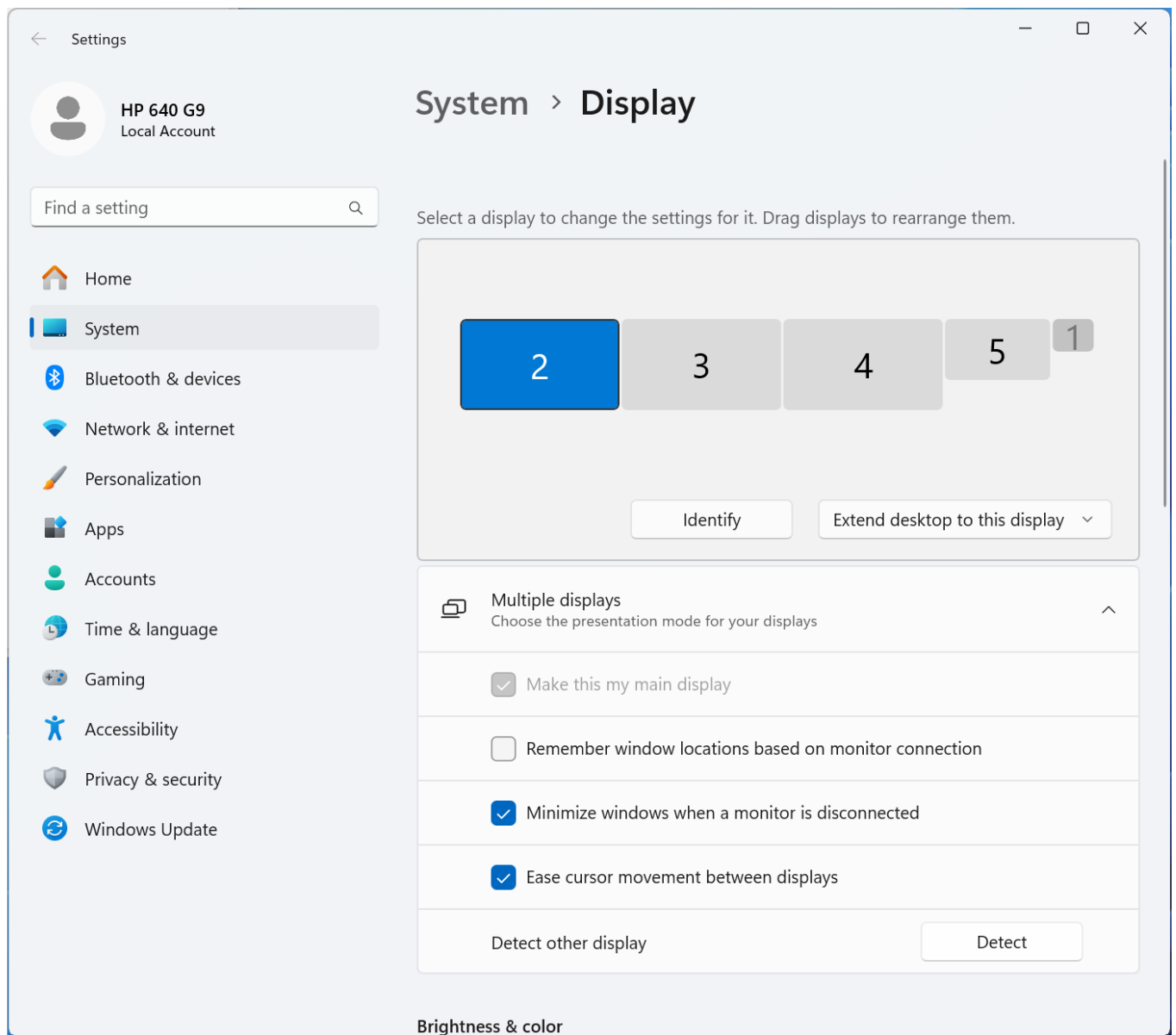

3. Scroll down to the "**Multiple Displays**", and select the mode in the drop-down list that fits your need.

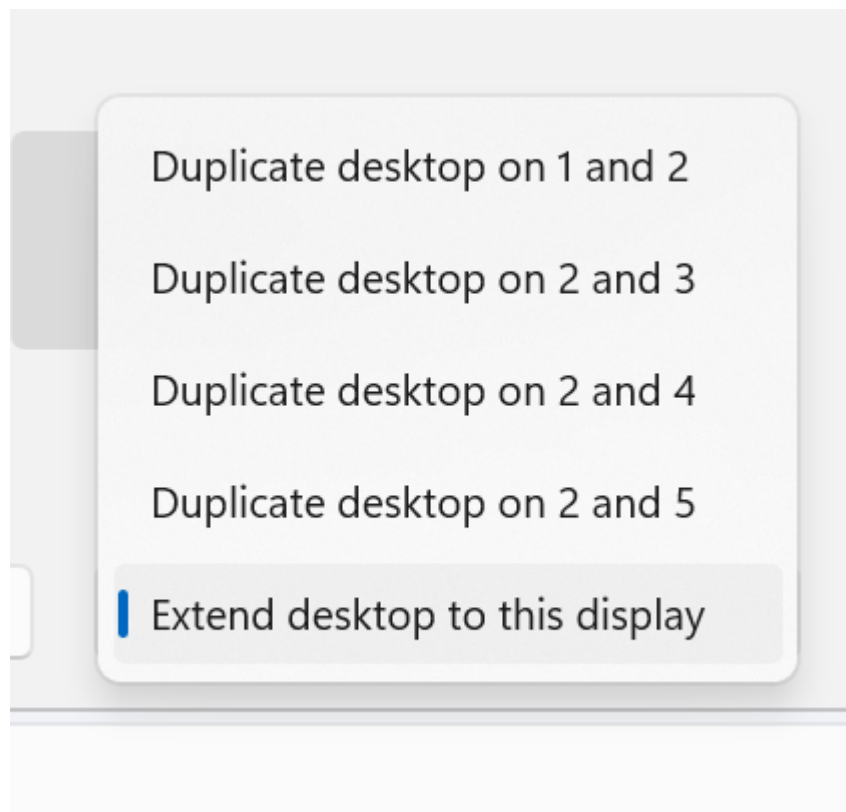

For macOS Users

1. Select "**System Preferences**" and choose "**Displays**".



2. Click on "**Arrangement**" to change the position of displays currently connected.

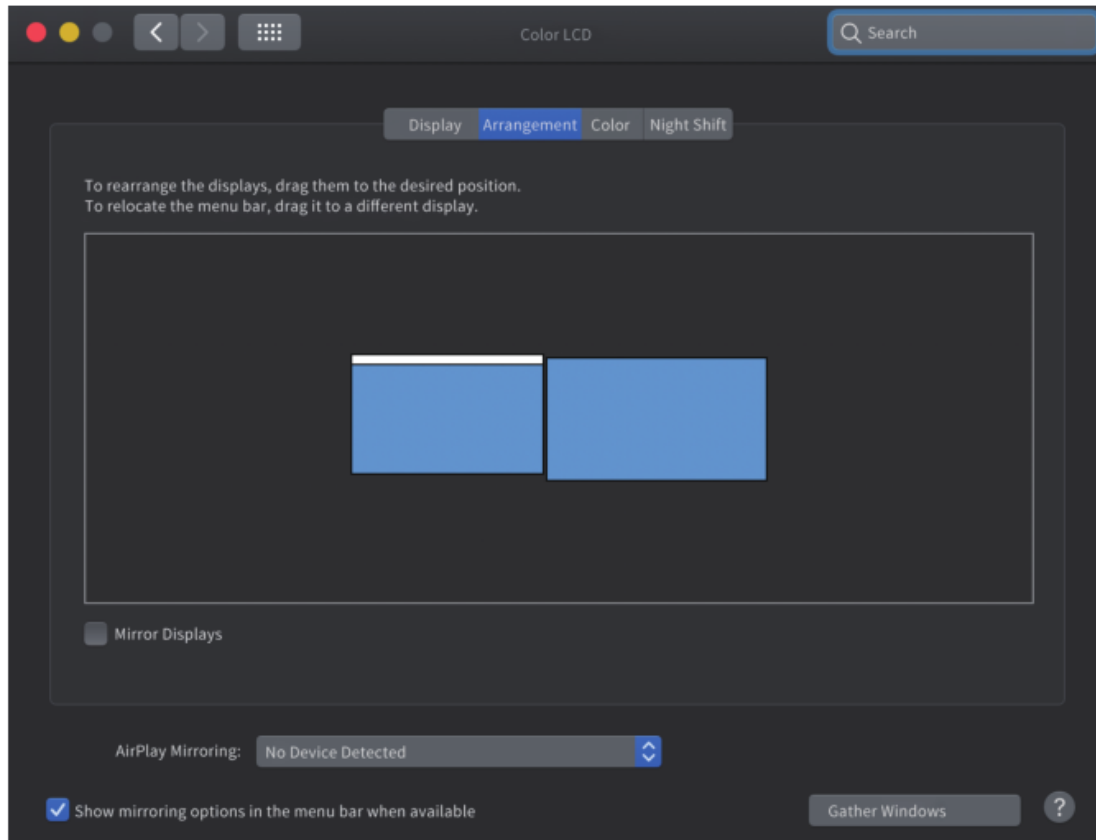

Extend Mode

3. Select either extend or mirror on your demand.

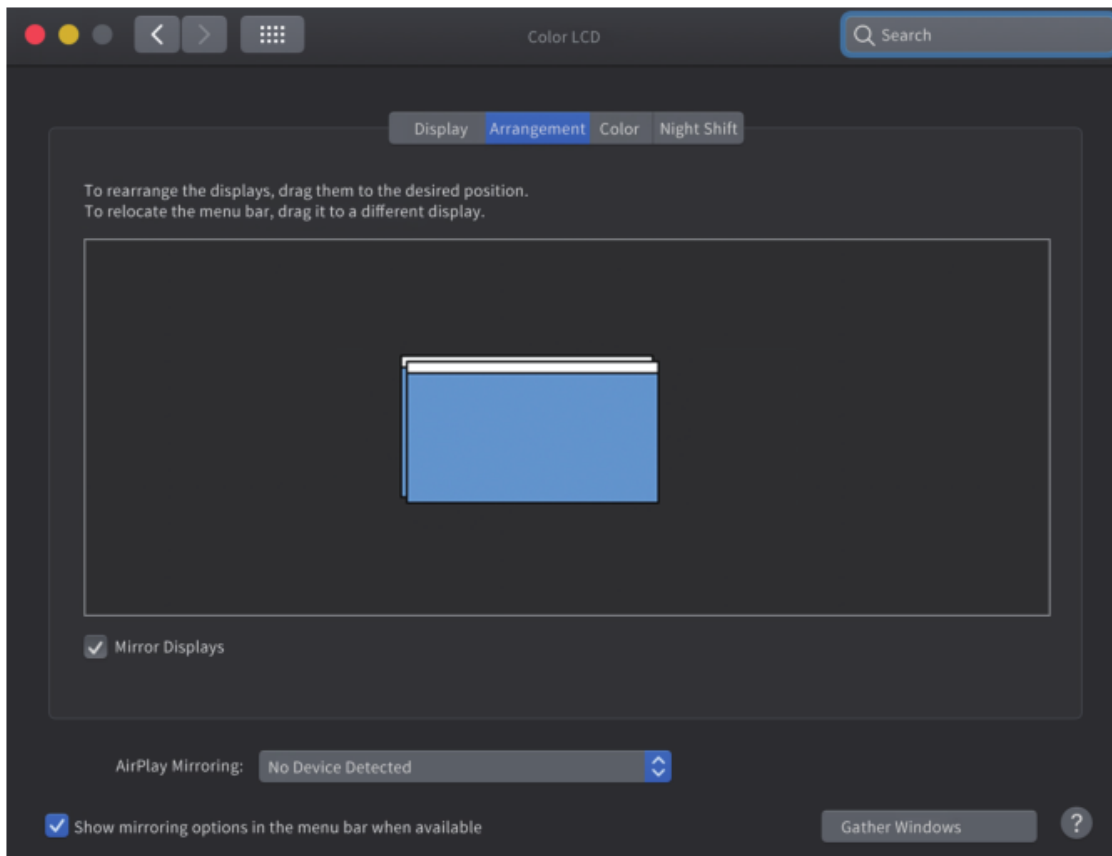

Mirror Mode

Chapter 3 Tips and Notice

This chapter introduces the Tips and notice in using.

It contains the following sections :

Tips

- When the power supply of the host device cannot support all ports working, please charge the dock through USB-C to make it running smoothly.
- HDMI and DP ports only can be used when the USB-C port of your host device(laptop/smart phone/tablet) can output video.
- For security, please use the adapter or cable that is original or owns a third-party certification to charge your laptop.

Notice

- Make sure the pin in the port does not sag or curve, so as not to affect its pluggable function.
- Keep liquids away from the products to prevent mechanic damages.
- Please keep the product in a dry, clean environment.

Chapter 4 FAQ and Aftersale Service

This chapter introduces the FAQ and aftersale service.

It contains the following sections :

- [FAQ](#)
- [Aftersale Service](#)

FAQ

Q1. Why there is no video output?

- 1.Please make sure the USB-C port of your devices supports Video Output (DP ALT MODE).
- 2.Please check if the cable is well connected.
- 3.Please use the standard HDMI 2.1 cable.

Q2. Why there is no audio output from HDMI port?

- 1.Please make sure your monitor supports Audio output function.
- 2.Please set the external monitor as default Audio output device.

Q3. Why doesn't my docking station charge my laptop?

Please verify if your computer's OS supports PD over USB-C, and also identify which port has this functionality if multiple USB-C ports are available. Please note that some systems that charge over USB-C Thunder-bolt 3 may not support charging from universal docks, and may only charge from approved chargers and devices from the system manufacturer.

Q4. How to figure out the maximum resolution (DP 2.1 / HDMI 2.1) my laptop supports?

- 1.Firstly, check the Graphics card version of your laptop; Find "display adapter" in "Device Manager".
- 2.Check the information of Intel processors for details from <https://www.intel.com/content/www/us/en/support/products/80939/graphicsdrivers.html>

Q5.My Laptop/Desktop supports PD and DP ALT MODE, why is it still not working properly?

Please try to update the Laptop/Desktop's BIOS, Graphics Card and other Drivers to the latest version, or contact our Customer Service.

Aftersale Service

Need help?

We're here for you!



Online support: wavlink.com

Available Mon-Fri 8:30 am-5:30pm (UTC+8)



support@wavlink.com

Available Mon-Fri 8:30 am-5:30pm (UTC+8)



+1 8889730883 (US Local)

Mon-Fri 9:00 am - 10:00 pm (UTC-5)

www.wavlink.com



**Thank you for purchasing
WAVLINK product!**

